



ALCOHOL COUNTERMEASURE SYSTEMS

PRODUCT PRESENTATION 2016

SAF'IR™

Evidential Breathalyzer





SAF'IR is the industry leading portable evidential breath alcohol tester (EBT). Using infrared (IR) technology to ensure the highest available accuracy, the SAF'IR EBT detects the presence and concentration of alcohol in breath to meet legislative requirements.

With real-time analysis and mobile accuracy, evidence can be stored, printed in the field or downloaded via direct USB connection. GPS coordinate record storage, Bluetooth printing functionality, user-friendly graphic display, highly accurate sensor technology and robust construction are designed for superior use.

ALERT™ J4X

Professional Breathalyzer





ALERT is a portable breath alcohol tester (PBT) used in commercial and law enforcement operations.

The ALERT J4X uses a high performance electrochemical sensor – the standard for portable evidential breath testers used by law enforcement.

Providing quick response and rapid recycle between tests, the ALERT J4X uses one button operation and an iconic display to guide the user through the testing sequence.

ALERT™ J5

Professional Breathalyzer





ALERT is a portable breath alcohol tester (PBT) used in commercial and law enforcement operations.

The ALERT J5 uses a high performance electrochemical sensor – the standard for portable evidential breath testers used by law enforcement.

Providing both active and passive breath sampling functionality, increased storage capacity and Bluetooth printing capability, the ALERT J5 delivers enhanced professional accuracy in a compact single-unit design.

ALCOSCAN™

Passive Breath Alcohol Tester





ALCOSCAN is an easy-to-use, passive breath alcohol tester that detects the presence of alcohol within the ambient environment.

The highly sensitive electrochemical sensor quickly processes a sample from the air and provides the results in seconds with no mouthpieces or special attachments required.

DRIVESAFE™

Personal Breathalyzers





DRIVESAFE exec uses a high performance electrochemical sensor, the standard for professional breathalyzers, ensuring stability and accuracy.

Icons on the LCD screen guide the user confidently through the test sequence. All functions are controlled using a single button.

DRIVESAFE exec has a simple, robust design for effective use in clinical or industrial settings. It displays results using a large, 3-digit LCD screen, along with a graphical intensity meter and tri-colour backlight for clarity.



DRIVESAFE elite uses a high performance electrochemical sensor, the standard for professional breathalyzers, ensuring stability and accuracy.

Results are displayed on a 4-digit LCD screen guide or 3 LED (Pass,Warn,Fail) on the BT (Bluetooth) version. Both guide the user confidently through the test sequence.

DRIVESAFE elite has a compact design for easy, discreet use, with results being displayed quickly and clearly.



DRIVESAFE élan uses a high performance electrochemical sensor, the standard for professional breathalyzers, ensuring stability and accuracy.

The DRIVESAFE élan smartphone App provides an effortless interface. The App records your height, weight and gender for personalized functions when estimating your Breath Alcohol Concentration (BrAC).



DRIVESAFE evōC uses a high performance electrochemical sensor, the standard for professional breathalyzers, ensuring stability and accuracy.

The DRIVESAFE evōC smartphone App is simple and intuitive. The App displays and stores test results and gives an estimated time to recover sobriety.

ALCOSENTRY™

Alcohol Screening System



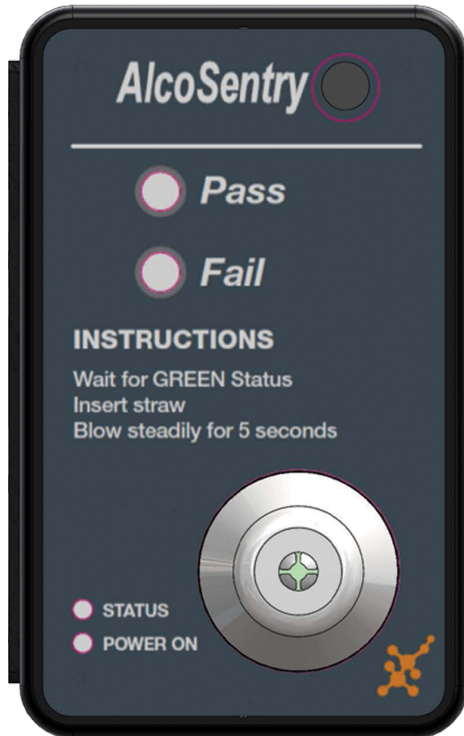

ALCOSENTRY access control system with breath alcohol monitoring controls access to secure environments and processes as an autonomous unit or through connection with a LAN.

Designed for safety sensitive industries with high volume screening requirements, ALCOSENTRY ensures safety of personnel.

Fully automated and non-invasive, ALCOSENTRY is designed for accuracy, security and ease of use.

RELIANT™

Remote Alcohol Monitoring





RELIANT RMU provides a means of confirming adherence to alcohol-free or zero tolerance policies for persons on probation or supervision. Its portability enables offender monitoring at home or in the workplace.

RELIANT RMU enables monitoring personnel to remotely determine compliance of offenders with biometric ID, location based breath alcohol measurements and interactive reporting capabilities.

RELIANT RMU uses GPS coordinates with data and time stamp to track offender progress with real time reporting through GSM, Wi-Fi or LAN.



RELIANT VMU provides a means of confirming adherence to alcohol-free or zero tolerance policies for persons on probation or supervision.

RELIANT VMU enables monitoring personnel to remotely determine compliance of offenders with biometric ID, location based breath alcohol measurements and interactive reporting capabilities.

RELIANT VMU uses GPS coordinates with data and time stamp to track offender progress with real time reporting through GSM, Wi-Fi or LAN.

ALCOLAB™

Breath Alcohol Tester



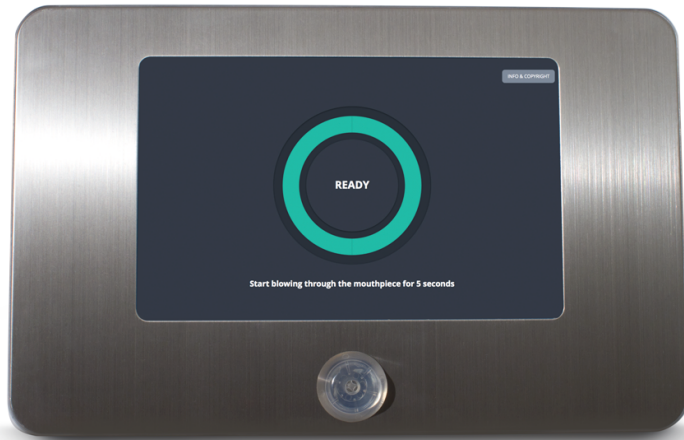

ALCOLAB test point features industry leading technology for alcohol monitoring in the workplace or in public venues. It is built for convenience, safety and accuracy with an interactive display within a compact, light weight, durable design.



ALCOLAB test point connects with Bluetooth or LAN to provide multifunctional applications in bars, clubs or restaurants, corporate events and safety control.

DrugWipe®

Drug Screening Solution





DrugWipe is the leading choice for police officers, customs officials, border control, rehabilitation clinics and correctional facilities for oral fluid (saliva) based testing for drugs of abuse.

Designed to test for a range of drugs:

- Amphetamines
- Benzodiazepines
- Cannabis
- Cocaine
- Ketamine
- Methamphetamines
- Opiates

DrugWipe reliable and hygienic, requiring only 10 µL test sample by swabbing the tongue. It delivers accurate test results in minutes.

ALCOLOCK™





ALCOLOCK LR alcohol interlock is designed for compliance programs for drink driving offenders and prevents a vehicle from being started unless the driver provides an accepted breath sample with an alcohol concentration below the pre-set limit.

ALCOLOCK LR records event data from each breath test and enables secure transmission to a central server for reporting to jurisdictional authorities. It may also be integrated with the FOCUS camera for driver identification.

ALCOLOCK LR provides ease of use while preventing tampering to comply with international performance standards, and features optional wireless communication through Wi-Fi or GPRS, and GPS coordinates for the recorded event data.



ALCOLOCK L series of alcohol interlocks provide a range of solutions for commercial management programs.

The ALCOLOCK L series provides integrated solutions for use with taxi meters, vehicle controllers and telematic devices to monitor and control the use of the vehicle. They also feature wireless communications for data transmission via Wi-Fi, GPRS or Bluetooth, GPS coordinates for the recorded event data and fleet monitoring through ALCOFLEET web services application.

ALCOLOCK L series are also designed for OEM installation at the factory or through service centers in the aftermarket.



ALCOLOCK L series Electronic Control Units (ECUs) are specifically designed for commercial safety management programs.

The ALCOLOCK L series ECU enables full event data recording, flexible program management and oversight through ALCOFLEET web services application.

The ALCOLOCK L series is designed for use in the trucking, coach and bus, school transportation, taxi, mining and construction industry. For large fleet operations requiring multiple communication options to small fleet vehicles or taxis in which the smallest ECU form factor is required, the ALCOLOCK L series ECUs meet each customer's unique fleet management requirements.



ALCOLOCK V3 alcohol interlock is designed for commercial (fleet) safety management programs. It prevents a vehicle from being started unless the driver provides an accepted breath sample with an alcohol concentration below the pre-set limit.

Rugged and reliable, ALCOLOCK V3 enables fleet managers to monitor operational vehicles remotely through a secure network application and telematic integration.

Metrology



ALCOSIM™

Breath Alcohol Simulator





ALCOSIM breath alcohol simulator is an easy and accurate way to calibrate or verify breath alcohol testing instruments.

Carefully maintaining the temperature of alcohol reference solution to within 34 ± 0.02 °C, it produces an air-alcohol sample of precise concentration.

ALCOSIM is fully compatible for use by ISO 17025 qualified test laboratories for testing the accuracy of breath alcohol testing instruments.

ALCOSIM™

calibration bench

Calibration Solutions

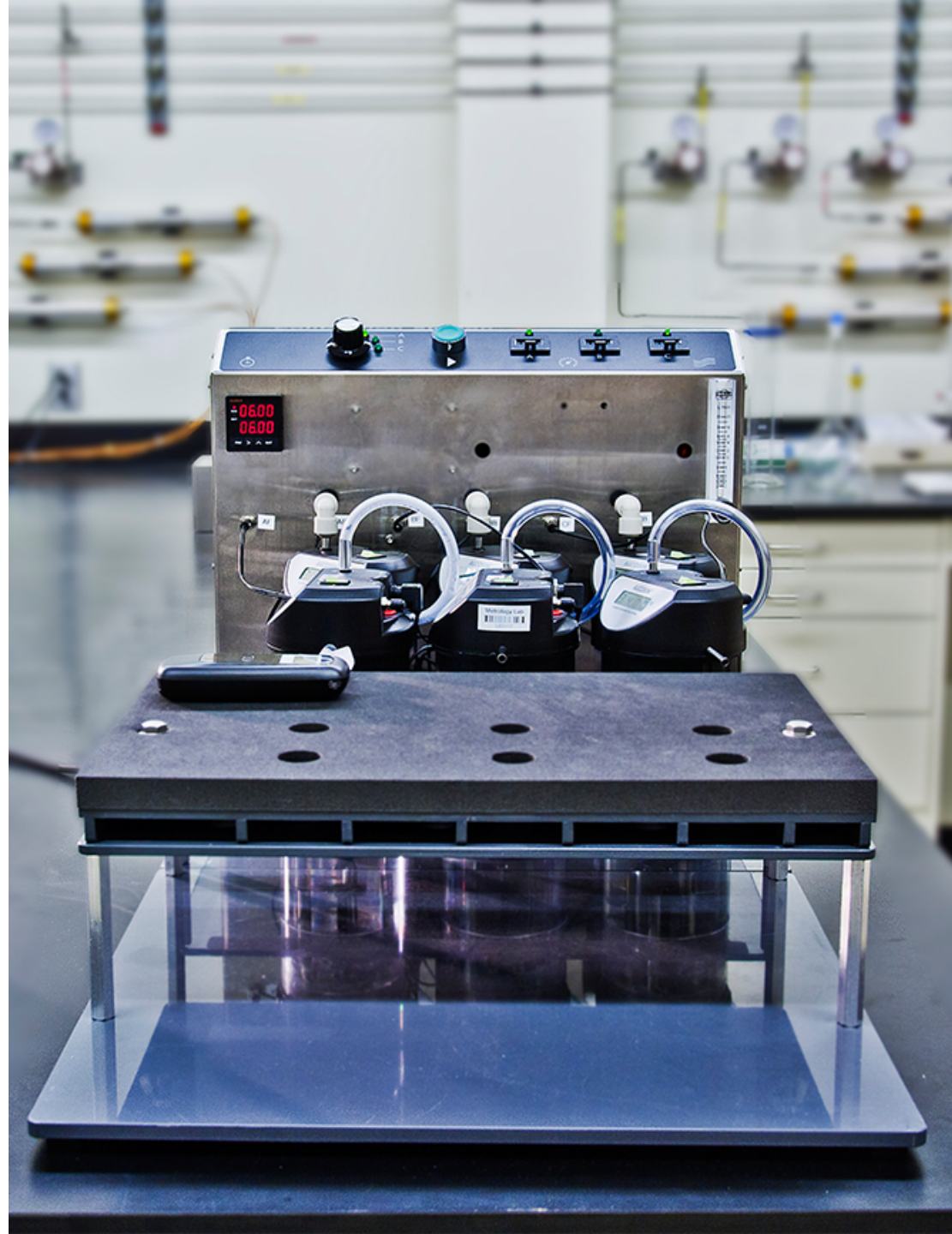

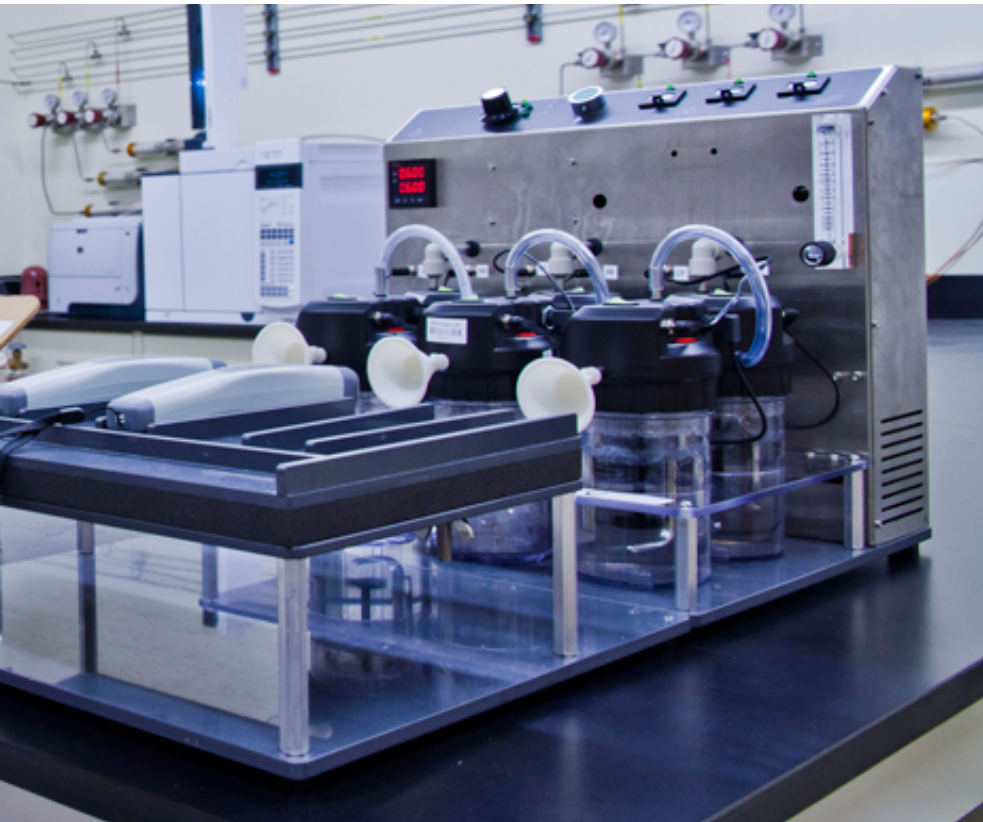

ALCOSIM calibration bench is a multi-tiered laboratory station that optimizes gas flow, alcohol reference solution use, eliminates human error and provides consistent simulated breath samples for calibration of all handheld breath alcohol testers.

Three tandems of ALCOSIM breath alcohol simulators can be used with different concentrations of alcohol reference solution, calibrating a breath tester to a wide range of thresholds to accommodate varied operational requirements.

ALCOSIM™

Metrological Test Bench

Calibration Solution

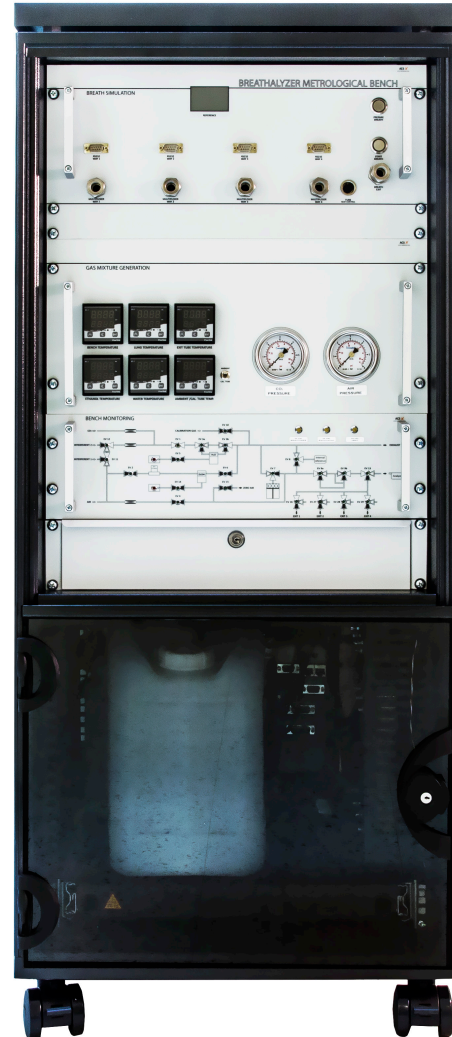



The Metrological Test Bench is designed for type testing of breath alcohol instruments against international standards and also provides the means for high volume verification testing of EBTs, where efficiency and accuracy are critical customer requirements.

Using a combined system which optimizes mass flow control and proportional valve release, the Metrological Test Bench provides high flexibility, multiple component mixture and optimal pressure, flow, temperature and volume control.

ARS™

Alcohol Reference Solutions





ACS alcohol reference solution (ARS) is premixed, ready for immediate use with a breath alcohol simulator, eliminating the requirement of mixing in the field.

The accuracy of the alcohol reference solution concentration is traceable to the NIST (National Institute of Standards and Technology_) reference standard and has a verified two (2) year shelf life.

Certifications

ACS is proud of its operations and quality management.
We have achieved some of the industry's best known quality
management certifications.

