

ALCOSENTRY

BREATH ALCOHOL TESTER



Instruction manual

Federal Communications Commission (FCC) Disclaimer

Changes or modifications not expressly approved by the party responsible for compliance could void the user's authority to operate the equipment.

To comply with Radio Frequency (RF) exposure requirements, a separation distance of at least 20 cm must be maintained between the antenna(s) of the Electronic Control Unit (ECU) and all persons.

This device complies with Part 15 of the FCC rules. Operations are subject to the following 2 conditions:

1. This device may not cause harmful interference.
2. This device must accept any interference received, including interference that may cause undesired operations.

Industry Canada

This device complies with Industry Canada licence-exempt RSS standard(s). Operation is subject to the following two conditions:

1. This device may not cause interference, and
2. This device must accept any interference, including interference that may cause undesired operation of the device.

Industrie Canada

Le présent appareil est conforme aux CNR d'Industrie Canada applicables aux appareils radio exempts de licence. L'exploitation est autorisée aux deux conditions suivantes :

1. L'appareil ne doit pas produire de brouillage, et
2. L'appareil doit accepter tout brouillage radioélectrique subi, même si le brouillage est susceptible d'en compromettre le fonctionnement.

Certification

The ALCOSENTRY breath alcohol tester and other breath alcohol testing products of Alcohol Countermeasure Systems (ACS) comply with international standards for function and safety. For more details, contact ACS.



Alcohol Countermeasure Systems Corp

60 International Boulevard
Toronto, Ontario M9W 6J2 CANADA

T +1 416 619 3500

F +1 416 619 3501

info@acs-corp.com

acs-corp.com

ACS, ALCOHOL COUNTERMEASURE SYSTEMS, ALCOSENTRY and the “**Molly**” are trademarks of Alcohol Countermeasure Systems (International) Inc. and are used under license. Alcohol Countermeasure Systems is the trading style of Alcohol Countermeasure Systems (International) Inc.

© 2015 Alcohol Countermeasure Systems

The information disclosed in this document is the valuable property of Alcohol Countermeasure Systems and all copyright and other proprietary rights to this document are reserved. No reproduction of this document is permitted without the prior written consent of Alcohol Countermeasure Systems.

TABLE OF CONTENTS

Safety and precautions.....	1
Introduction.....	1
Disclaimer.....	2
Getting started.....	2
Operation.....	3
Testing.....	4
Power options.....	5
Calibration.....	5
Warranty.....	5
Service.....	5

SAFETY AND PRECAUTIONS

CAUTION

- Use this tester for its intended purpose only
- Do not blow smoke or fluids into the straw, as doing so may damage the sensor
- Before testing: Wait 20 minutes after drinking or eating and 3 minutes after smoking
- Do not store this tester in extreme heat or in extreme cold temperatures
- Use this tester within the ambient temperature range of 5 to 50 °C
- Do not disassemble the tester, as this may cause injury and void the warranty
- Keep magnets or mobile devices away from the tester to minimize the potential of electromagnetic interference
- Make certain that the exhaust grid is not covered when a breath test is being performed
- Always use a new straw when blowing into the tester

INTRODUCTION

Thank you for purchasing the ALCOSENTRY breath alcohol tester, a device designed for your safety.

This tester measures Breath Alcohol Concentration (BrAC). In some cases, it may take up to 60 minutes to reach the highest BrAC after the last consumption of alcohol.

Each person reacts uniquely to the consumption of alcohol and may become impaired at a point below the legal limit.

DISCLAIMER

Sale of the ALCOSENTRY is on the express condition that neither the manufacturer nor the vendor of the device shall be held responsible for the accuracy of any breath alcohol test reading obtained from the device, nor liable for any loss, damage, injury or other consequence resulting, directly or indirectly, from the use thereof.

GETTING STARDED

The ALCOSENTRY breath alcohol tester is simple to use. The BrAC readout is provided with 2 Test Result LEDs.

The parts and basic features of the tester are illustrated as follows:

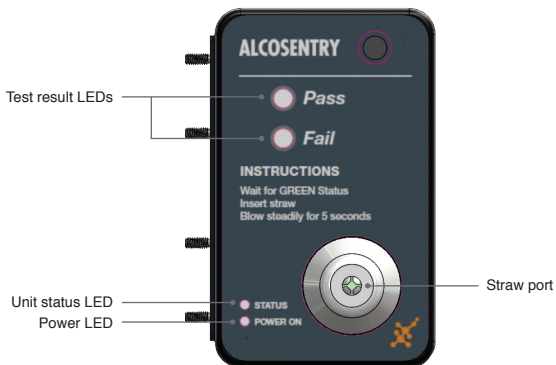

OPERATION

The ALCOSENTRY breath alcohol tester is easy to use and understand.

ON

Whenever the unit is turned on, the **POWER ON** LED is RED.

READY

Whenever the unit is ready for a test, the **STATUS** LED blinks GREEN.

ERROR

A **STATUS** LED blinking RED indicates an error. Please contact ACS.

TEST

Insert a new straw and blow steadily into it for 5 seconds. A tone will sound to indicate proper breath flow.

ABORT

Three beeps indicate that a proper breath sample was not provided. Wait for the **STATUS** LED to blink GREEN before performing another test.

READING

To indicate the BrAC range, the device displays:

- **Pass** LED (GREEN) - to indicate an alcohol reading below the set threshold
- **Fail** LED (RED) - to indicate an alcohol reading above the set threshold

OFF

The ALCOSENTRY will automatically turn off when the power supply is disconnected.

TESTING

NOTE: To achieve accurate results, insert a new straw each and every time the ALCOSENTRY is used.

1. Power on the tester and wait for the GREEN **STATUS** LED to appear.
2. Blow steadily and continuously into the straw for 5 seconds.

A continuous tone will sound to indicate proper breath flow – the GREEN **STATUS** LED will remain steady.

If the breath sample is intermittent, too hard or too soft, 3 beeps will sound and the **STATUS** LED will turn off. Wait for the GREEN **STATUS** LED to blink and retry.

3. Stop blowing when the tone ends and a click is heard. The breath sampling process is now complete.

The ALCOSENTRY will analyze the sample and display the test result within a few seconds.

CAUTION! Be aware that alcohol is present in many products such as breath spray, mouthwash and medicine, as well as in certain foods and beverages, which may distort BrAC results.

BEFORE testing: Wait 20 minutes after eating or drinking and 3 minutes after smoking.

POWER OPTIONS

The ALCOSENTRY is available in 3 different power configurations:

- USB mini connected to a laptop
- Power adapter (36Vmin.)
- PoE (Power Over Ethernet)

The ALCOSENTRY and other breath alcohol testing products of Alcohol Countermeasure Systems comply with international standards for function and safety.

CALIBRATION

To maintain accuracy, the ALCOSENTRY requires calibration each year from the first date of use. If the tester is due for a calibration, contact an authorized Service Centre.

WARRANTY

The ALCOSENTRY breath alcohol tester is warranted against defects in materials or workmanship for 1 year from the date of purchase. During the warranty period, Alcohol Countermeasure Systems agrees to replace or repair any unit or part that in its judgement is found to be defective, providing the defect is not due to damage or misuse.

SERVICE

Testers requiring service should be packed securely and shipped prepaid to an authorized Service Centre. Contact Alcohol Countermeasure Systems for more details:

Email: service@acs-corp.com

Website: acs-corp.com

