

ALCOLOCK™ V3

SERIES B-2 WI-FI



Instruction Manual

Alcohol Countermeasure Systems Corp

60 International Boulevard

Toronto, Ontario M9W 6J2 CANADA

T +1 416 619 3500

F +1 416 619 3501

info@acs-corp.com

acs-corp.com

TYPE APPROVAL: ECE REGULATION NO.10

1. This type approval follows only the specifications regarding the electromagnetic compatibility.
2. The device must be installed according to all applicable technical rules, directives and regulations.
3. The national regulations and behavioral rules must be observed when using this device.

ACS, ALCOHOL COUNTERMEASURE SYSTEMS, ALCOLOCK and the “**Molly**” are trademarks of Alcohol Countermeasure Systems (International) Inc. and are used under license. Alcohol Countermeasure Systems is the trading style of Alcohol Countermeasure Systems Corp.

© 2015 Alcohol Countermeasure Systems

The information disclosed in this document is the valuable property of Alcohol Countermeasure Systems and all copyright and other proprietary rights to this document are reserved. No reproduction of this document is permitted without the prior written consent of Alcohol Countermeasure Systems.

FRONT VIEW

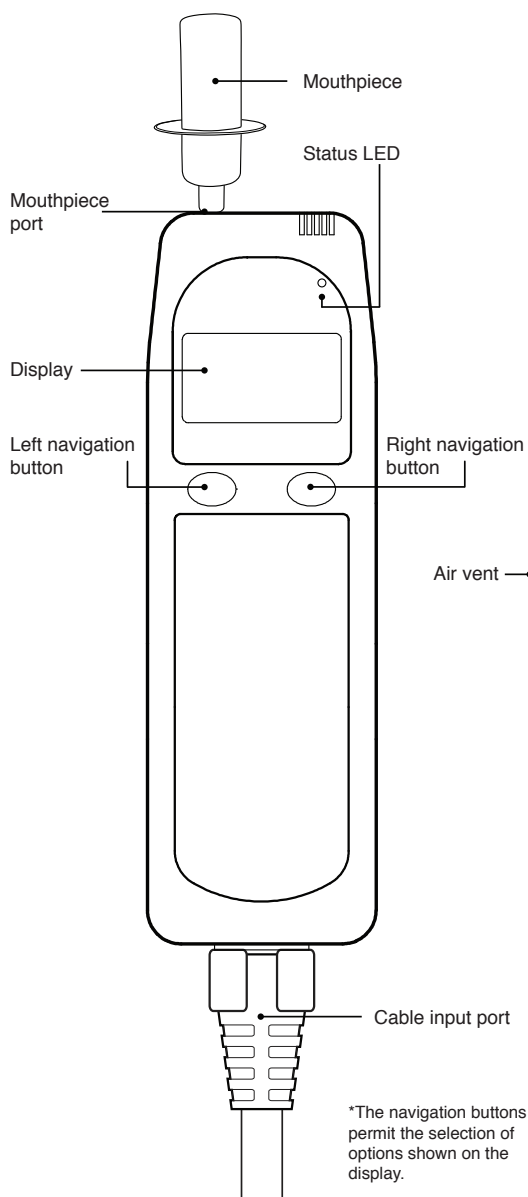

SIDE VIEW

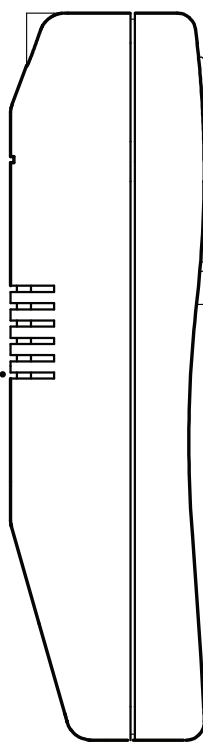

*The navigation buttons permit the selection of options shown on the display.

TABLE OF CONTENTS

Safety and Precautions	1
Warranty	1
Maintenance.....	1
Introduction	2
What is an alcohol interlock?.....	2
How does it work?	2
Installation	2
More information	2
Using the ALCOLOCK V3 alcohol Interlock	3
Starting the motor.....	3
Restarting the motor.....	5
Running retests (optional)	5
Sharing a vehicle.....	6
Overriding the ALCOLOCK V3 alcohol interlock	7
Menu options	8
Dates	8
Volume set.....	8
Wake-up mode	9
Sleep mode	9
Time	10
Language selection	10
Downloading data over Wi-Fi	11
Wi-Fi transfer process	11
Wi-Fi troubleshooting	12
Maintenance & troubleshooting	13
Accessing maintenance functions	13
Servicing the vehicle	13
Calibration	13
Troubleshooting table.....	13
Display messages	14
Disposal of the ALCOLOCK V3 alcohol interlock at the end of its service life	16
Replacement parts	16
Index	17

SAFETY AND PRECAUTIONS

The ALCOLOCK V3 alcohol interlock is a device that is designed for easy and safe operation. The following precautions should be followed:

- Do not open the handset case. Doing so will void the warranty and potentially damage the components within
- Avoid exposing the handset to direct sunlight for extended periods of time
- If any liquid is spilled on the handset, remove with a cloth and allow the handset to dry thoroughly. If there is excessive water damage, do not power on the handset. Contact your dealer
- Keep all radio frequency (RF) devices (such as cell phones) away from the handset to ensure minimal interference

WARRANTY

All ACS products are warranted to be free of defects in workmanship and materials for one year from the date of shipment.

ACS agrees to replace or repair any defective ALCOLOCK V3 device, provided the defect was not caused by misuse or mishandling.

Any ALCOLOCK V3 device being returned for warranty repair must be properly packaged and shipped prepaid to the authorized dealer's facility.

MAINTENANCE

The ALCOLOCK V3 alcohol interlock is made for field use, making it susceptible to dirt and debris. The handset should be cleaned with a damp cloth and mild soap. Do not use abrasive cleaners or solvents.

Periodic maintenance and calibration is required. Contact your dealer for more information.

INTRODUCTION

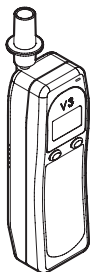

WHAT IS AN ALCOHOL INTERLOCK?

An alcohol interlock is an in-vehicle breath alcohol testing device. It prevents a vehicle from starting if it detects that a driver's breath alcohol concentration (BrAC) is over a preset limit. It is designed to fit inside the vehicle near the driver's seat and connects directly to the vehicle's ignition system. The device consists of a handset and an ECU. The ECU enables or disables the ignition of the motor and stores the handset settings.

HOW DOES IT WORK?

The ALCOLOCK V3 alcohol interlock uses the same alcohol sensing technology used by police in roadside screening. A special alcohol-sensitive cell detects the amount of alcohol in the breath. Breath alcohol concentration (BrAC) is directly proportional to the amount of alcohol in the blood. The blood alcohol concentration limit is customizable and can be set to any specific jurisdictional requirement.

INSTALLATION

The ALCOLOCK V3 alcohol interlock is to be installed by a qualified technician in accordance with national regulations. An unqualified installation may invalidate the type approval of the vehicle.

MORE INFORMATION

ALCOHOL INFLUENCE ON TESTING

Drinking alcohol and eating foods containing alcohol will cause a failed breath test.

Some other factors that may affect a test (because they may contain or produce residual alcohol in the mouth) are: medicines, menthol drops, burping, smoking, using mouthwash or mouth spray.

Rinsing the mouth with water after using mouthwash or mouth spray will remove alcohol content.

Do not eat, smoke or drink for at least 10 minutes before taking a test.

Do not spray any air fresheners, disinfectants, cologne or perfume in the vehicle prior to a test, as these can also contain alcohol.

NOTE: There are additional items that may affect the results of a breath test. Follow this guide carefully to avoid incorrect results.

OPERATING TEMPERATURE

The maximum ambient operational temperature is between -40 and +85 °C.

NOTE: Depending on ambient temperature, handset warm up may take approximately 30 seconds at 20 °C and approximately 1 minute at 0 °C for the 24V ECU.

BATTERY VOLTAGE

The voltage supplied to the ECU, which powers the handset, is supplied by the vehicle battery.

For a 12V device, the vehicle battery voltage can range from 9 to 18V. For a 24V device, the vehicle battery voltage can range from 16 to 36V.

USING THE ALCOLOCK V3 ALCOHOL INTERLOCK

STARTING THE MOTOR

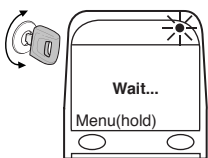

1. Turn the handset power on by pressing the *right* button. **Wait...** is displayed during warm-up. A yellow indicator light flashes.

Alternatively, the power can be turned on by switching the ignition key on and off.

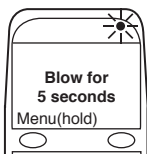

2. The handset displays **Blow for 5 seconds** with a flashing green indicator light when it is ready for a breath test. The warm-up time is longer in colder temperatures.

NOTE: Do not store the mouthpiece in a cold area. This causes condensation in the mouthpiece and increases the opportunity for water to enter the handset.

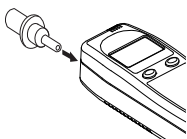

3. Insert a new mouthpiece. Using a new mouthpiece practices good hygiene and ensures a good breath sample.

NOTE: Do not eat, drink or smoke for at least 10 minutes before taking a test. This could contaminate the breath sample.

4. Blow into the mouthpiece while listening for a tone indicating proper breath flow. If you are not blowing correctly, a message is displayed providing instructions on how to blow correctly.
5. Stop blowing when the handset tone stops and the handset beeps. **Wait...** is displayed as the breath sample is analyzed.

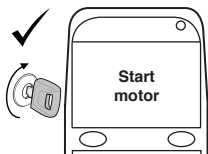

START MOTOR

The breath test passed and no alcohol is detected. You may start the motor.

NOTE! The motor must be started within 5 minutes*.

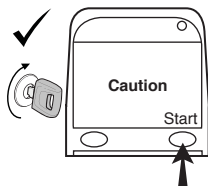

CAUTION

The breath test passed, but alcohol below the limit has been detected. There are 2 options:

- Wait 5 minutes* and try the test again if you are certain there is no alcohol in your breath.
- Select **Start** to acknowledge you will be driving with alcohol in your system.

NOTE! The motor must be started within 5 minutes*.

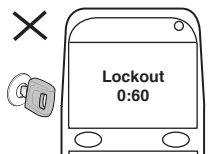

LOCKOUT

The breath test failed. The alcohol level detected is over the preset limit. You may not start the motor.

Lockout and a countdown timer are displayed. Wait for the timer to expire before attempting another breath test.

WARNING! Do not attempt another breath test until you are sure that your alcohol level is under the limit. A second failed breath test may result in a longer lockout time.

* This value is customizable. Please contact your administrator for your device settings.

RESTARTING THE MOTOR

If the motor is turned off for less than 5 (or 30) minutes* (time depends on the settings of the device), it can be restarted without providing another breath test. This is a safety feature if the motor stalls, or convenient for frequent short stops.

Observe the message on the handset:

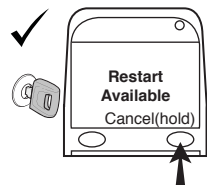

RESTART AVAILABLE

The motor can be restarted without providing another breath test.

To cancel the restart, press and hold the *right* button.

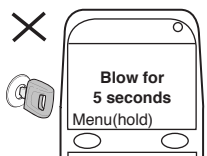

BLOW FOR 5 SECONDS

The restart period has expired and a passed breath test is required to start the motor.

Refer to the "Starting the motor" section.

RUNNING RETESTS (OPTIONAL)

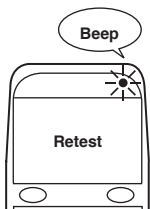

1. The handset beeps and **Retest** is displayed.

Do not provide a breath test while the vehicle is in motion. The ALCOLOCK V3 alcohol interlock allows a few minutes for the user to stop in a safe location.

2. Provide a breath sample and observe the display message:

DRIVE SAFELY

The breath test passed, you can continue driving.

PULL OVER, TURN OFF MOTOR

The alcohol level is above the preset limit. The motor must be turned off. **Lockout** and a countdown timer are displayed until another breath test can be attempted. You cannot start the motor until a passed breath test is provided.

WARNING! Do not attempt another breath test until you are sure that your alcohol level is under the limit. A second failed test may result in a longer lockout time.

* This value is customizable. Please contact your administrator for your device settings.

SHARING A VEHICLE

Drivers with their own handsets can operate the same vehicle without reprogramming the ALCOLOCK V3 alcohol interlock. All the custom settings are downloaded into the ECU when a new handset is connected.

The handset can be changed with the motor on or off.

It is recommended to exchange handsets when the motor is off and the vehicle is parked in a safe location.

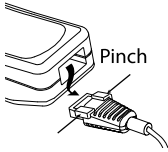

1. Pinch the connector at the sides and pull the cable away from the handset to disconnect.

WARNING! Do not pull on the handset cord. It requires just a gentle squeeze on the release tabs to disconnect.

2. If the motor is running, the ECU beeps every 15 seconds until the handset is reconnected.

If the motor is off the ECU will not beep.

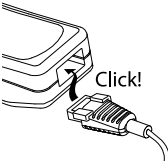

3. Reconnect the handset to the handset cable. It clicks if it is properly connected.

All the handset settings are downloaded to the ECU.

NOTE: If the handset is replaced while the motor is running, a breath test is required.

OVERRIDING THE ALCOLOCK V3 ALCOHOL INTERLOCK

In emergency situations, the ALCOLOCK V3 device can be overridden using a four-digit Override Code provided by your dealer. This code is randomly generated and changes daily. The use of the override function is stored in the log.

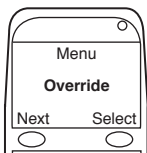

1. Press and hold the *left* button to access the Main Menu. Press the *left* button to scroll to **Override**. Select with the *right* button.



2. Select **[+]** to increase the number and **Next** to move the digits. Once entered, select **Next** to move to **OK?** and press the *right* button to select.

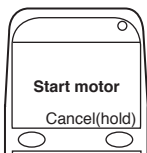

3. The handset beeps and displays **Start motor**. A breath test will be required again the next time the motor is started.

If the code is incorrect, the handset beeps and there is no action. Verify that the code is correct and re-enter.

MENU OPTIONS

The ALCOLOCK V3 alcohol interlock has a number of menus and customizable options such as language selection, time adjustment, sleep and wake-up time settings. All are found in the Main Menu, which is accessed by pressing and holding the *left* button.

DATES

The current clock date and time, calibration dates, lockout date and service date are found in this menu.

Calibration is required annually to maintain optimum accuracy. A reminder is displayed on the handset 14 days before the calibration expiry date.

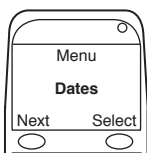

1. Press and hold the *left* button to access the Main Menu. Press the *left* button to scroll to **Dates**. Select with the *right* button.
2. Use the *left* button to scroll through the dates (**Lockout**, **Service**, **Calibration**, **Cal. Expiry** and **Current**).
3. Press and hold the *right* button to exit the Dates Menu.

VOLUME SET

The handset uses audio tones. The volume of the tones is set from the Main Menu.

NOTE: The volume setting is for the handset only. The volume of the ECU cannot be set.

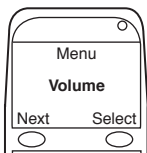

1. Press and hold the *left* button to access the Main Menu. Press the *left* button to scroll to **Volume**. Select with the *right* button.
2. Use the *left* and *right* buttons to adjust the volume up or down.
3. Press and hold the *right* button to save the setting and exit the Volume Menu.

WAKE-UP MODE

The handset has the capability to wake up 3 times a day. This ensures that the handset is warmed up and ready before entering the vehicle.

NOTE: Before using this option, be sure the vehicle battery has a sufficient charge.

The wake-up option is automatically disabled if the handset is not used for three consecutive days.

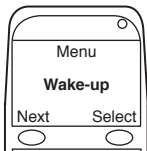

1. Press and hold the *left* button to access the Main Menu. Press the *left* button to scroll to **Wake-up**. Select with the *right* button.
2. Select a time slot by placing the cursor underneath **on / off**. Set the wake-up time for that slot. The *left* button moves the cursor and the *right* button changes the value.
3. Press and hold the *right* button to save the time selection and exit the Wake-up Menu.

SLEEP MODE

The handset can be put into sleep mode manually or automatically when the ignition is off. This conserves the vehicle battery.

To put the handset into sleep mode manually, press and hold both buttons. To put the handset into sleep mode automatically:

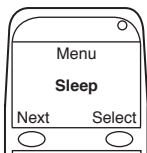

1. Press and hold the *left* button to access the Main Menu. Press the *left* button to scroll to **Sleep**. Select with the *right* button.
2. The Sleep Menu contains 4 pre-programmed times: **5, 30, 60** and **90** minutes. Use the *left* button to scroll and select the time.
3. Press and hold the *right* button to save the time selection and exit the Sleep Menu.

TIME

The time of the handset can be adjusted when changing time zones and Daylight Savings Time.

This time adjustment is primarily for the wake-up feature and does not change the times in the Dates Menu.

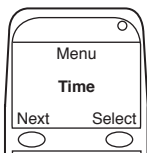

1. Press and hold the *left* button to access the Main Menu. Press the *left* button to scroll to **Time**. Select with the *right* button.
2. The current time is displayed with the option to increment the time by +/- 0.5 to 3.0 hours. Select **[+]** to increase the time and **[-]** to decrease it.
3. Press and hold the *right* button to save the time setting and exit the Time Menu.

LANGUAGE SELECTION

The ALCOLOCK V3 alcohol interlock is available in multiple languages. The selections are made at the time of order and are programmed at the factory.

Contact your dealer for more information about additional languages.

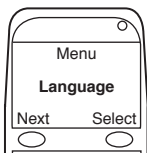

1. Press and hold the *left* button to access the Main Menu. Press the *left* button to scroll to **Language**. Select with the *right* button.
2. Use the *left* button to scroll through the languages. Stop at the new language selection.
3. Press and hold the *right* button to save the language selection and exit the Language Menu.

DOWNLOADING DATA OVER WI-FI

WI-FI TRANSFER PROCESS

The ALCOLOCK V3 B-2 Wi-Fi can only download content with a V3 Wi-Fi network registered to the vehicle. Downloading cannot start until the vehicle is stationary and the ignition switch is in the off position.



1. Drive to a V3 Wi-Fi network area.

Verify the signal strength. 4 bars is the maximum; 2 bars is the recommended minimum.

Park the vehicle. **Drive Safely** is displayed



2. Turn the ignition off.

RESTART AVAILABLE may appear briefly while the device establishes a Wi-Fi connection.

Wi-Fi connecting is displayed while the handset connects to a V3 Wi-Fi network with a yellow indicator light.

Once connected, the handset beeps twice.

WARNING: Do not turn the ignition switch on during the download phase, or the connection will abort automatically.



3. The handset transmits wireless data and **Transmitting data** is displayed.

The handset beeps every 5 seconds with a yellow indicator light to signify transmission.

NOTE: Data transmission should take between 1 to 2 minutes if the vehicle downloads on a weekly basis.



4. **Transaction complete 02** is displayed when the download is complete.

Proceed to "In Case of Failed Transaction" if **Transaction failed** is displayed.



5. The handset will beep with a yellow indicator light. **Clearing Log Please Wait** is displayed.

NOTE: *This step is a background process and may not appear on the screen.*



6. When the log is cleared, **Restart available** is displayed.

NOTE: *You may cancel this process at any time by pressing and holding the right button.*

Proceed to the next step if **Restart available** is not displayed.

IN CASE OF A FAILED TRANSACTION



If the transaction fails, a failure tone will be heard with a red indicator light. **Transaction failed** is displayed for 5 seconds or longer, depending on the cause of the failure (see “Troubleshooting” for failure codes).

Proceed to “Wi-Fi Troubleshooting”.

WI-FI TROUBLESHOOTING



The signal dBm, IP address, ACS network SSID, date and failure code are displayed in the Wi-Fi Menu.

The Wi-Fi signal strength is displayed on the top right and top left of the screen. The variances are as follows:

- 4 bars (very strong) 0 to 39
- 3 bars (strong) 40 to 59
- 2 bars (okay) 60 to 74
- 1 bar (weak) 75 to 89
- 0 bars (very weak) 90 to 255

The failure code is displayed on the bottom right corner of the screen and can be interpreted as follows:

- 90 the handset is disconnected
- 91 the ITE application is not available
- 92 invalid data from the device
- 93 the transaction was interrupted
- 94 the device has been recently serviced
- 95 the device is not installed/registered
- 96 the device is not recognized for this network

MAINTENANCE & TROUBLESHOOTING

ACCESSING MAINTENANCE FUNCTIONS

ALCOLOCK V3 alcohol interlock maintenance functions can only be accessed by your dealer using a System Code provided from ACS. This code is randomly generated and changes daily. The use of this function is stored in the log.

SERVICING THE VEHICLE

When the vehicle requires service and an ALCOLOCK V3 device is installed, a Dealer Code provided from your dealer can be used to start the motor. This code is randomly generated and changes daily. The use of this code is stored in the log.

CALIBRATION

Yearly calibration is required to maintain optimum breath test accuracy. The handset displays a message 14 days before a calibration is due. A calibration is performed with either the ALCOSIM breath alcohol simulator or an alcohol gas standard cylinder.

TROUBLESHOOTING TABLE

The following table lists basic problems that may occur, along with their solutions. For other problems, contact your dealer.

IF THE V3...	YOU SHOULD...
Will not turn on	Check the vehicle battery
Displays an error code	Refer to the “Display Messages” section of this manual
Aborts a breath test	Retry the test, or investigate the Abort Code
Is in permanent lockout	Contact your dealer
Requires service	Contact your dealer

DISPLAY MESSAGES

The ALCOLOCK V3 alcohol interlock may not accept a breath test and could display error messages instead. To minimize errors, make sure that the handset is connected properly, the vehicle's battery is in good condition and that mobile phones are not in use during breath tests. The following is a list of messages (including error messages) that the handset may display:

DISPLAY MESSAGES	DESCRIPTION	WHAT TO DO
ADR-incompatible	Certain vehicles require an ADR approved handset to transport hazardous goods. The error occurs when a non-ADR handset is connected to an ADR approved vehicle.	Find the correct ADR approved handset and connect it to the vehicle.
Battery error	The RTC batteries of the handset and/or ECU are depleted.	Contact your dealer to arrange for service.
Calibration expired *	Occurs when the handset is not calibrated before the expiry date. You may be able to start your motor, or your motor may be blocked from starting; this depends on your device settings.	Contact your dealer to have the device calibrated.
Cancelled Try again	The breath test was cancelled before completion.	Retry the test. If the message persists, contact your dealer.
Clock error	The internal clock circuit has failed. The handset will still operate correctly, but the time and date information will be incorrect.	Contact your dealer.
Communication error	The handset and the ECU are not communicating properly. Ensure that the handset cable is securely connected to the handset.	Contact your dealer.
Error Code 10, 30, 40, 45, 50	There is a problem with the handset.	Retry the test. If the message persists, contact your dealer.

Invalid sample	The handset could not analyze the breath sample that was given.	Retry the test. If the problem persists, contact your dealer.
Missed retest	Occurs when a retest is not done within the 3 minute time frame.	Complete the test as required.
Pull Over, Turn Off Engine	Occurs in response to a failed alcohol test while driving.	Pull over at the first safe opportunity and turn the motor off. Wait 5 minutes before attempting another test.
RF-error	There is a strong radio frequency (RF) source in the near vicinity of the handset.	Try to shield the handset from any surrounding antennas, including mobile phones. If there is no change, contact your dealer.
Service Due	Reminder that a service appointment is coming up.	Arrive at the scheduled time for the appointment.
Service Required *	The service period has expired. You may be able to start your motor, or your motor may be blocked from starting; this depends on your device settings.	Contact your dealer to have your vehicle serviced.
Start Violation	A violation occurs if you start the vehicle without passing a breath test. The device requests a retest, and the Start Violation message is displayed, followed by a retest request.	Take the breath test and contact your dealer.
Technical error	An internal failure has occurred. The motor can still be started as normal with no breath test required.	The ALCOLOCK V3 alcohol interlock should be serviced as soon as possible.
Try again	There is a problem with the test.	Try the test again. Call your dealer if the problem persists.
Voltage too low / Voltage too high	The handset or the ECU is not receiving the correct supply voltage.	Check your vehicle battery. If the problem persists, contact your dealer.

* For a **Calibration expired** or a **Service Required** display message, you may be able to start your motor, or your motor may be blocked from starting; it depends on your device settings. If you are allowed to start your motor, select **Start**. If you are not permitted to start your motor, **Start** will not be displayed above the right button. Please contact your administrator for more information.

DISPOSAL OF THE ALCOLOCK V3 ALCOHOL INTERLOCK AT THE END OF ITS SERVICE LIFE

Return to your dealer for removal of the ALCOLOCK V3 alcohol interlock from your vehicle. Following the removal, disposal of the device (the ECU, handset, or both) at the end of its service life can be done by:

- Returning the device to your dealer for disposal
- Contacting your local waste management authority for more information on the appropriate disposal methods to be followed
- Asking a suitable disposal contractor to dispose of the device

REPLACEMENT PARTS

Contact your dealer for the following parts:

Mouthpieces (bag of 25) ACS #95-000250.

INDEX

A

Alcohol influence, 2
Alcohol interlock, 2

B

Battery voltage, 3

C

Calibration, 13
Caution, 4
Clock, 8, 10

D

Dealer code, 13
Display messages, 14, 15
Disposal, 16

E

Emergencies, 7
Exchanging handsets, 6

F

Failed transaction, 12
Failure code, 12

I

Installation, 2

L

Language, 10
Lockout, 4
Log, 7, 12

M

Main menu, 8
Maintenance, 13
Motor restart, 5
Motor start, 3

O

Operating temperature, 3
Override, 7

R

Replacement parts, 16
Retests, 5

S

Sharing a vehicle, 6
Sleep mode, 9

T

Troubleshooting, 12, 13

V

Volume, 8

W

Wake-up mode, 9
Wi-Fi, 11, 12

